



North Carolina Department of Cultural Resources

State Historic Preservation Office

David L. S. Brook, Administrator

James B. Hunt Jr., Governor
Betty Ray McCain, Secretary

Division of Archives and History
Jeffrey J. Crow, Director

November 13, 2000

MEMORANDUM

To: William D. Gilmore, P.E., Manager
Project Development and Environmental Analysis Branch

From: David Brook *for David Brook*
Deputy State Historic Preservation Officer

Re: Widening of SR 1129 (Groometown Road) from SR 1383 to SR 1479.
TIP No. U-3313, Greensboro, Guilford County, ER 00-8431

Thank you for your letter of October 1, 2000, transmitting the survey report by Richard L. Silverman, for the above referenced project. For purposes of compliance with Section 106 of the National Historic Preservation Act, we concur that the following property is eligible for listing in the National Register of Historic Places:

- ✓ Pleasant Grove Baptist Cemetery (formerly Red Hill Cemetery) is eligible under Criterion A as it represents an example of a rural community cemetery that began no later than the 1820s. The cemetery also satisfies Criteria Consideration A as it also represents the early foundations of a community in early nineteenth-century Guilford County. We concur with the boundaries as noted on page 14 of the report.

The following properties, previously determined eligible for listing in the National Register remain eligible with their previous boundaries:

- Sedgfield Stables
- Celia Phelps Methodist Episcopal Church

The above comments are made pursuant to Section 106 of the National Historic Preservation Act and the Advisory Council on Historic Preservation's Regulations for Compliance with Section 106 codified at 36 CFR Part 800.

Thank you for your cooperation and consideration. If you have any questions concerning the comment, contact Renee Gledhill-Earley, Environmental Review Coordinator, at 919 733-4763.

cc: Mary Pope Furr, NCDOT
Nicholas Graf, FHWA

bc: BROWN/MONTGOMERY
COUNTY
RF

	Location	Telephone/Fax
ADMINISTRATION	507 N. Blount St., Raleigh NC	617 (919) 733-4763 • 733-8653
ARCHAEOLOGY	421 N. Blount St., Raleigh NC	619 (919) 733-7342 • 715-2671
RESTORATION	515 N. Blount St., Raleigh NC	613 (919) 733-6547 • 715-4801
SURVEY & PLANNING	515 N. Blount St., Raleigh NC	4618 Mail Service Center, Raleigh NC 27699-4618 (919) 733-6545 • 715-4801

HISTORIC ARCHITECTURAL RESOURCES SURVEY REPORT

**PHASE II - ABRIDGED
FINAL IDENTIFICATION & EVALUATION**



**WIDENING OF SR 1129 - GROOMETOWN ROAD
FROM SR 1383 – WILEY DAVIS ROAD TO
SR 1479 – WAYNE ROAD IN GREENSBORO,
GUILFORD COUNTY, NC**

**GUILFORD COUNTY
TIP # U-3313
STATE PROJECT # 8.2494601
FEDERAL AID PROJECT # STP-1129(4)**

**North Carolina Department of Transportation
Report Prepared by Richard L. Silverman, Architectural Historian**

September 2000

HISTORIC ARCHITECTURAL RESOURCES SURVEY REPORT
PHASE II - ABRIDGED
FINAL IDENTIFICATION & EVALUATION



WIDENING OF OF SR 1129 - GROOMETOWN ROAD
FROM SR 1383 - WILEY DAVIS ROAD TO
SR 1479 - WAYNE ROAD IN GREENSBORO,
GUILFORD COUNTY, NC

GUILFORD COUNTY
TIP # U-3313
STATE PROJECT # 8.2494601
FEDERAL AID PROJECT # STP-1129(4)

North Carolina Department of Transportation
Report Prepared by Richard L. Silverman, Architectural Historian
September 2000

Richard L. Silverman
Principal Investigator
Historic Architecture Section
North Carolina Department of Transportation

9-29-00
Date

Mary Pope Furr
Mary Pope Furr, Supervisor
Historic Architecture Section
North Carolina Department of Transportation

9-29-00
Date

I. MANAGEMENT SUMMARY

The North Carolina Department of Transportation (NCDOT) proposes to widen SR 1129 (Groometown Road) to multi-lanes from SR 1183 (Wiley Davis Road) to SR 1479 (Wayne Road) in Greensboro, Guilford County, North Carolina (MAP-1). The purpose of the project is to alleviate congestion from the ongoing and anticipated development in the area and to improve safety on SR 1129 (Groometown Road). The project length is 1.2 miles. This project is federally funded [FA# STP-1129(4)].

A Final Identification and Evaluation Survey (Phase II) was conducted to determine the Area of Potential Effects (APE), and to identify and evaluate all structures over fifty years of age within the APE according to the Criteria of Evaluation for the National Register of Historic Places (MAP-2). Five properties were identified in this survey. Among these, two were shown at a consulting meeting between NCDOT and the State Historic Preservation Office (SHPO) on 7 September 2000 and determined not eligible and not worthy of further evaluation.

In a previous NCDOT environmental study, **Sedgefield Stables** and **Celia Phelps Methodist Episcopal Church** were determined eligible for the National Register (DOE) on 22 April 1991 (See APPENDIX A). These properties were identified and evaluated in the Greensboro Western Urban Loop, Guilford County (U-2524) Historic Architectural Resources Survey Report. On 1 September 2000 and 13 September 2000, Historic Architectural Resource Surveys were conducted to confirm the historic boundaries and to document any significant changes made to these two properties since 1991. Based on these surveys, NCDOT Historic Architecture concurs with the 1991 DOE status and boundaries for these two properties. Further, Historic Architecture has no plans to re-evaluate these properties as part of this environmental study.

The remaining property, the **Pleasant Grove Baptist Cemetery (formerly Red Hill Cemetery)**, has been evaluated in this report according to National Register Criteria. It is the conclusion of the principal investigator that the Pleasant Grove Baptist Cemetery is eligible for the National Register under Criterion A for event. At present, there are no properties in the APE that are listed on the National Register.

Properties Listed on the National Register or State Study List

None

Properties Previously Determined Eligible for the National Register (DOE)

See Appendix A

Property #1 - Sedgefield Stables (DOE-1991)

Property #2 - Celia Phelps Methodist Episcopal Church (DOE-1991)

Properties Considered Eligible for the National Register

Property # 3 - Pleasant Grove Baptist Cemetery (formerly Red Hill Cemetery)

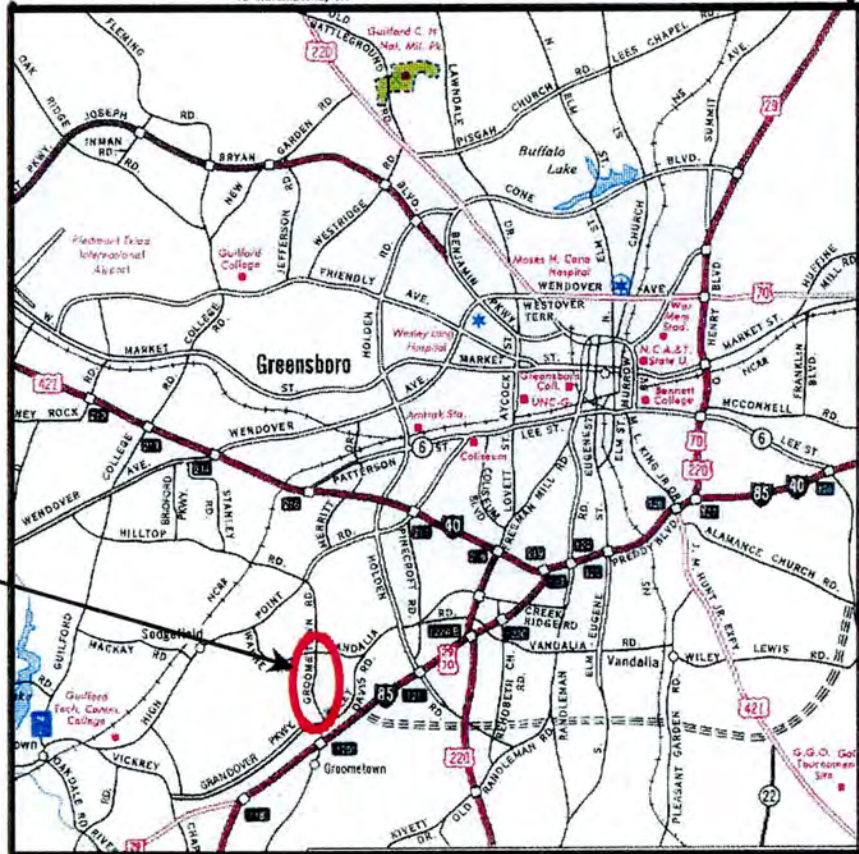
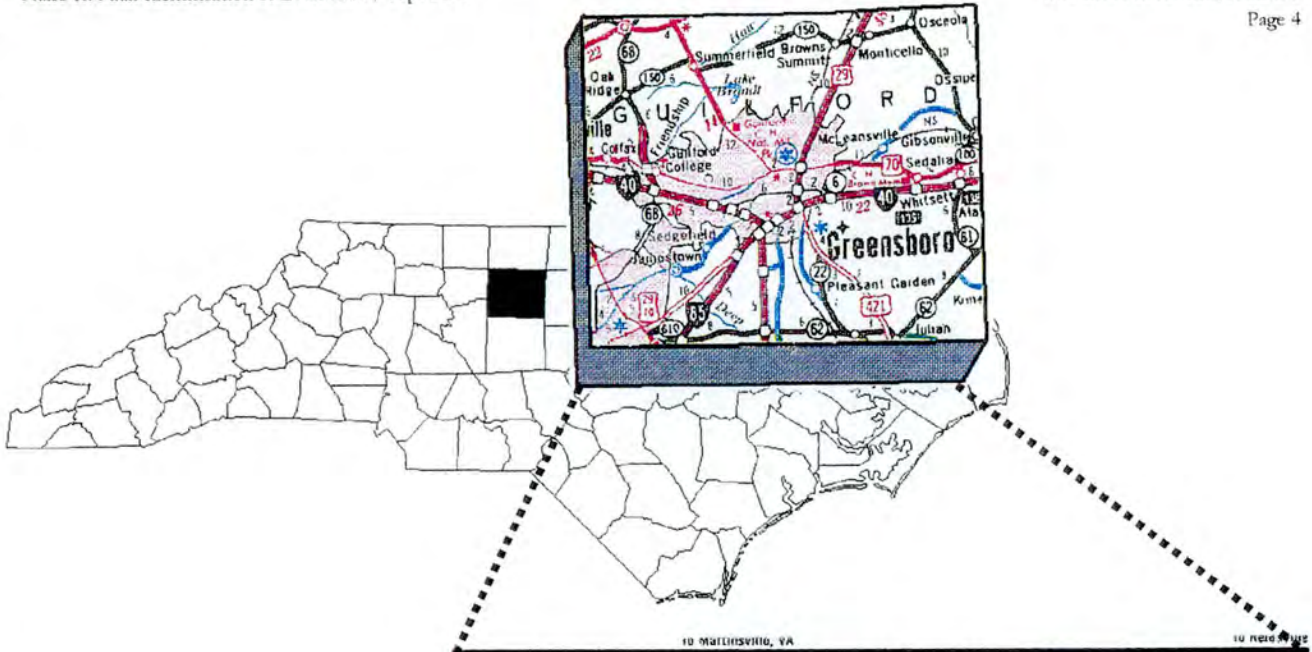

U-3313
Project
Vicinity



Historic Architecture
 NCDOT
 1 South Wilmington Street
 P.O. Box 25201
 Raleigh, NC 27611-5201
 T 919-733-7844
 F 919-733-9794
 www.dot.state.nc.us

Project
SR 1129 - Groomtown Road
Greensboro, North Carolina

Sheet Title
PROJECT VICINITY MAP

Drawn By:
Silverman

Issue Date:
09-14-00

File Name:
map_1.ppt

TIP No.
U-3313

Scale

Sheet No.
MAP-1

Property #1
 Sedgefield Stables
(DETERMINED ELIGIBLE IN 1991)
 See Appendix A for NR Boundary

Property #2
 Celia Phelps Methodist Episcopal Church
(DETERMINED ELIGIBLE IN 1991)
 See Appendix A for NR Boundary

Property #3
 Pleasant Grove Baptist Cemetery
(ELIGIBLE)
 See Map-3 for NR Boundary

AREA OF POTENTIAL EFFECTS (APE)
 SHOWN DASHED

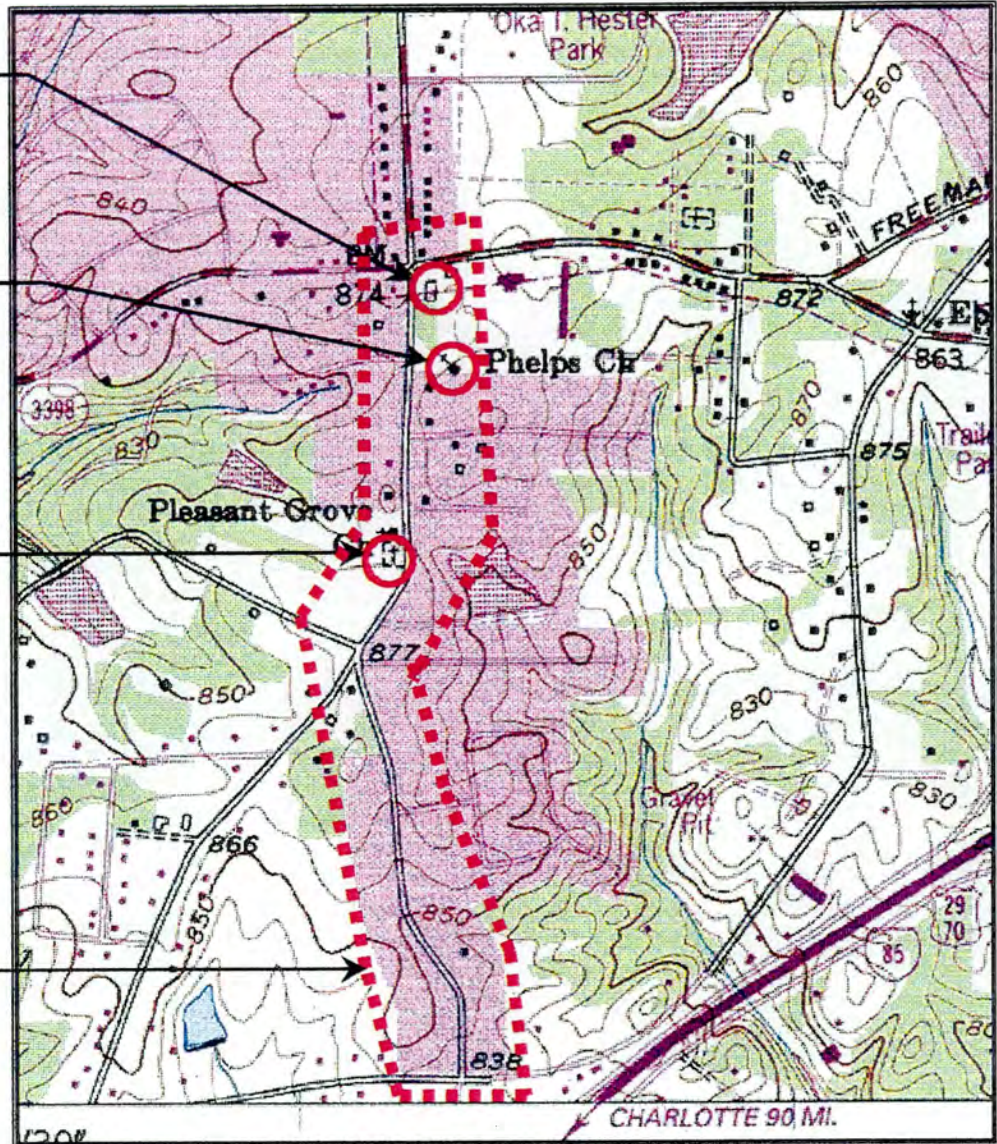

Historic Architecture
 NCDOT
 1 South Wilmington Street
 P.O. Box 25201
 Raleigh, NC 27611-5201

T 919-733-7844
 F 919-733-9794
 www.dot.state.nc.us

Project

**SR 1129 - Groometown Road
 Greensboro, North Carolina**

Sheet Title

**PROJECT MAP
 (with Area of Potential Effects)**

Drawn By:
Silverman

Issue Date:
 09-14-00

File Name:
map_2.ppt

TIP No.

U-3313

Scale

Sheet No.

MAP-2

II. TABLE OF CONTENTS

- I. MANAGEMENT SUMMARY AND MAPS
 - II. TABLE OF CONTENTS
 - III. PURPOSE OF SURVEY AND REPORT
 - IV. METHODOLOGY
 - V. DESCRIPTION OF PROJECT AREA
 - VI. SUMMARY RESULTS OF FINDINGS
 - A. PROPERTIES UNDER FIFTY YEARS OF AGE
 - B. PROPERTIES CONSIDERED ELIGIBLE FOR THE NATIONAL REGISTER
 - C. PROPERTIES DETERMINED NOT ELIGIBLE FOR THE NATIONAL REGISTER AND NOT WORTHY OF FURTHER EVALUATION
 - VII. BIBLIOGRAPHY
-
- APPENDIX A. PROPERTIES PREVIOUSLY DETERMINED ELIGIBLE (DOE) UNDER GREENSBORO WESTERN URBAN LOOP (U-2524) HISTORIC ARCHITECTURAL RESOURCES SURVEY REPORT, 1991.
 - APPENDIX B. CONCURRENCE FORM FOR PROPERTIES NOT ELIGIBLE FOR THE NATIONAL REGISTER

III. PURPOSE OF SURVEY AND REPORT

This survey was conducted and the Phase II report prepared in order to identify historic architectural resources located within the APE as part of the environmental studies conducted by NCDOT and documented by an Environmental Assessment (EA). This report is prepared as a technical addendum to the EA and as part of the documentation of compliance with the National Environmental Policy Act (NEPA) and the National Historic Preservation Act (NHPA) of 1966, as amended. This report is on file at NCDOT and is available for review by the general public. Section 106 of the NHPA of 1966, as amended, 16 U.S.C. Section 470f, requires Federal agencies to take into account the effect of their undertakings on properties included in or eligible for inclusion in the National Register of Historic Places and to afford the Advisory Council on Historic Preservation a reasonable opportunity to comment on such undertakings.

IV. METHODOLOGY

NCDOT conducted the survey and prepared this Phase II report in accordance with the provisions of Federal Highway Administration (FHWA) Technical Advisory T 6640.8A (Guidance for Preparing and Processing Environmental and Section 4(f) Documents); the Secretary of the Interior's Standards and Guidelines for Archaeological and Historic Preservation (48 FR 44716); 36 CFR Part 800; 36 CFR Part 60; and Survey Procedures and Report Guidelines of NCDOT and the National Park Service. In addition, this report conforms to the expanded requirements for architectural survey reports developed by NCDOT and the North Carolina SHPO dated February 2, 1996. NCDOT conducted a Final Identification and Evaluation survey with the following goals:

- (1) To determine the APE, defined as the geographic area or areas within which a project may cause changes in the character or use of historic properties, if any such properties exist.
- (2) To identify all significant resources within the APE.
- (3) To evaluate these resources according to the National Register of Historic Places Criteria.

The survey methodology consisted of a field survey and historical background research of the project area. On 1 September 2000 and 13 September 2000 field surveys were conducted by automobile and on foot, covering 100% of the APE. All structures over fifty years of age were photographed and keyed to a USGS quadrangle map.

Background research about the project area concentrated on the architectural development and the historical context of the project area. Investigators conducted an examination of deeds, tax records, and maps located in the Guilford County Courthouse and the North Carolina State Archives. There are no properties in the APE listed on the National Register and no properties listed on the North Carolina State Study List. Two properties were previously determined eligible for the National Register (DOE) as part of a previous NCDOT Historic Architectural Resources Survey Report (U-2524), Sedgefield Stables

(DOE-1991) and Celia Phelps Methodist Episcopal Church (DOE-1991). See "Appendix A" for documentation on these properties.

V. DESCRIPTION OF THE PROJECT AREA

This project is situated in the Greensboro, North Carolina USGS quadrangle map in Greensboro, Guilford County, North Carolina (MAP-1). The general project area is characterized by a mix of highway commercial properties, churches, cemeteries, as well as numerous mid-to-late-20th century single-family dwellings. The project corridor runs along a north-south axis, north of Interstate 85. The Pleasant Grove Cemetery is located on the west side of SR 1129 (Groometown Road) .1 mile north of the intersection with SR 1382 (Lake Drive). The Pleasant Grove Baptist Church street address is 3812 Groometown Road.

VI. SUMMARY RESULTS AND FINDINGS

Five properties were identified in this survey. Among these, two were shown at a concurrence meeting between NCDOT and the SHPO on 7 September 2000 and determined not eligible and not worthy of further evaluation. These properties are represented in this report with photographs and brief reasons for their ineligibility.

Two properties, **Sedgefield Stables** and **Celia Phelps Methodist Episcopal Church** were previously determined eligible for the National Register (DOE) on April 22, 1991 and are included in "Appendix A" of this report. NCDOT Historic Architecture concurs with the 1991 DOE status and boundaries for these two properties. Further, Historic Architecture has no plans to re-evaluate these properties as part of these environmental studies.

The remaining property, the **Pleasant Grove Baptist Cemetery (formerly Red Hill Cemetery)**, has been evaluated in this report according to National Register Criteria. It is the conclusion of the principal investigator that the Pleasant Grove Baptist Cemetery is eligible for the National Register under Criterion A for event. At present, there are no properties in the APE that are listed on the National Register.

A. PROPERTIES UNDER FIFTY YEARS OF AGE

Criterion Consideration G, for properties that have achieved significance within the last fifty years, states that properties less than fifty years of age may be listed on the National Register only if they are of exceptional importance or if they are integral parts of districts eligible for the National Register. There are no properties in the APE that qualify for the National Register under Criterion Consideration G.

B. PROPERTIES CONSIDERED ELIGIBLE FOR THE NATIONAL REGISTER

Property #3 - Pleasant Grove Baptist Cemetery (formerly Red Hill Cemetery)

Location

The Pleasant Grove Baptist Cemetery is located at 3812 Groometown Road (SR 1129) on the west side of the roadway .1 mile north of the intersection of Lake Drive (SR 1382) in Guilford County, North Carolina. Adjacent to the cemetery on the north is the brick Colonial Revival church building, built in 1954 and expanded in 1964-65 (fig. 1). To the south of the cemetery is a water tower owned by the City of Greensboro. Directly to the west of the cemetery is the Groometown Road, the roadway for which planning studies are being undertaken by the North Carolina Department of Transportation.

Description

The Pleasant Grove Baptist Cemetery (fig. 2) is situated on a relatively flat site that maintains very few decorative or landscape features. The primary character-defining features are a wide, expansive lawn planted with oak, cypress, and holly trees and a hedgerow of holly bushes planted along Groometown Road (fig. 3). The western side of the cemetery is marked by a chain-link fence that also serves the adjacent athletic field.

Late-19th and 20th-century gravestones are laid out in aisles on a north-south axis. The early-19th and mid-19th-century stones are primarily flush-set into grade and made of slate (fig. 4). Lettering is hand-tooled into these early slates. Early stones do not appear to be oriented or arranged in a readily understood order, like their modern counterparts. Generally, the early stones that have been documented are located in the southeast quadrant of the cemetery, nearest the roadway. It is likely that some early graves are not marked, and therefore an underlying arrangement that is currently not perceived may have existed an earlier time.

Historic Context and Background Information

Church Property

The Pleasant Grove Baptist Church is situated on property that has been used for several different community purposes since the early-19th-century. A succession of church congregations have worshiped on this site, including the Pleasant Grove Baptist Church, the Red Hill Baptist Church, a Nazarene church, and the Red Hill Methodist Church. At different stages in the history of this property, these congregations and the surrounding community have used the site as a burial ground, for educational purposes, and as a place of worship.¹ Due to the successive waves of changes seen at this property, there are only a few tangible pieces of history remaining on the site. The most identifiable piece of the site's history is the cemetery, which remains an integral part of the present-day church property. There are no buildings on the site which predate 1954.

Church Buildings

Trustees of the Methodist Protestant Church purchased the original church property on 6 January 1870.² The earliest documentation for the construction of a church building, however, dates to 1896.³ According to surviving church records, The "Red Hill {Methodist} Church" was to be "sixteen feet high, thirty-two feet wide, and fifty feet long."⁴ A photograph of this building was taken in the early 1950s. It shows a two-bay gable-front building with a plain, projecting eave, weatherboard siding, and a small hipped-roof cupola (fig. 5). This building served the church until the dissolution of the congregation.

¹ Cockerham, et. al., "Seventy Years of Growth at Pleasant Grove Baptist Church, 1930-2000, (Greensboro: 2000), p.1."

² The land was sold to the church trustees for five dollars by James N. Millis and Jonathan Murphy. The church trustees were Thomas Burton, Sr., Abner Amfield, and Solomon Sullivan, Jr. (Cockerham, 1).

³ The presence of an earlier church on the site is possible, but has not been confirmed. (Cockerham, 1).

⁴ Cokerham, 1.

Family history gathered by Carl Bradfield, a writer and descendant of Sullivan family members (buried in the cemetery from the early 19th and into the 20th-century) suggests that there was an earlier church presence. Mr. Bradfield has written that “other churches were on that site. John L.[Sullivan] was six years old when the Civil War began, and he attended church there with his parents Solomon [Sullivan] Jr. and Elizabeth [Sullivan].” From information passed down through this family, Mr. Bradfield states that “the old church had large clay deposits nearby, since before the Civil War, where children played. And that is why people called it Red Hill.”⁵

While the 1896 building was originally built for a Methodist congregation, by the 1910s, the church was known as the Pilgrim Holiness Church. In the 1920s, the church was abandoned and lay vacant for a time, when the Sedgefield Country Club made plans to buy the property for expansion.⁶ This plan never materialized.

Into the 1930s, the building was being leased by the Red Hill Baptist Church congregation. This group purchased the building in 1937. Shortly thereafter, the church was renamed Pleasant Grove Baptist Church.⁷ The present brick Colonial Revival church building was constructed in three campaigns, the full basement with auditorium and classrooms (1954), sanctuary (1964-65), and education wing (1974). Still being used by Pleasant Grove is the cemetery site, located to the south of the church building.⁸

The School

Church history indicates that the “Red Hill School” stood on a parcel adjoining the church property. Guilford county maps from 1910⁹, 1920¹⁰, and 1924-25¹¹ call out the name of this school; however, there is no known architectural description nor surviving photograph of this building. It is not known when the school building was demolished.¹²

The Cemetery

The earliest documented use of this property is for a community cemetery, which dates to no later than the first quarter of the 19th-century. One of the earliest grave markers discovered in the cemetery reads, “J.R.S., 1754”. Genealogical research conducted by Carl Bradfield suggests that this stone may be attributed to Sgt. James Sullivan who was born in 1754 and died August 27, 1825.¹³ According to family research, James Sullivan was a veteran of the War of the American Revolution. James Sullivan and his wife Mary are believed to be the parents of the first of three

⁵ Carl Bradfield, Letter to Pleasant Grove Baptist Church, 1 March 1999.

⁶ Ibid.

⁷ Six classrooms were added in 1939-40. When the 1954 church was constructed, these classrooms were moved and adapted into a fellowship hall, later named the “Kenan Building.” The Kenan Building was demolished May 9, 1987. (Cockerham).

⁸ Mildred Cockerham, “Seventy Years”

⁹ Map of Guilford County, Board of County Commissioners, C.R. Lowe, Eng., 1924-25

¹⁰ 1920 Soil Map of Guilford County, United States Department of Agriculture, Bureau of Soils.

¹¹ 1910 Map of Guilford County, O.M. Miller, C.E., Salisbury.

¹² Guilford County Map Collection, North Carolina State Library and Archives.

¹³ 1825 is the oldest documented Sullivan burial date in this cemetery, according to Bradfield.

generations of Solomon Sullivans, all of whom are interred in this cemetery. The first Solomon Sullivan was born March 12, 1775 and died May 19, 1857.¹⁴

Another early tombstone found in the cemetery is for Leven Murphey, who was born June 16, 1800 and died on January 1, 1827. Other early Murphey interments date to 1840, 1841, and 1866. Though these two families, Sullivan and Murphey, maintain burials throughout the same periods, historical information on the Murphey family is not known.¹⁵

The earliest stones are situated in the southeast quadrant of the cemetery, nearest to Groometown Road. In 1996, a survey of the cemetery was published by Louise and Earl Hartgrove. According to their research, conducted in the early 1980s, "Red Hill was another country church graveyard where any and everybody could bury a loved one, and sadly, some with no gravestones to designate who, when and where."¹⁶ From their 1983 documentation of approximately 189 burials, the following statistics have been compiled:

Table I.
Pleasant Grove Baptist Cemetery (Red Hill Cemetery) Burial Statistics

<i>Period of Burials</i>	<i>Number</i>	<i>Percentage</i>
Early 19 th -Century to 1865	11	6%
1865 to 1899	21	11%
1900 to 1945	97	51%
1946 to 1983	60	32%
Early 19 th Century to 1983	189	100%

Burial statistics demonstrate that approximately 83% of documented burials are 20th century, with nearly a third of all burials in the cemetery dating from the post-World War II era. This period of burials coincides with the development of the Red Hill Methodist Church in 1896 and its successor, the Pleasant Grove Baptist Church that exists to this day. Documented burials prior to 1900 comprise only 17% of the total, while antebellum burials comprise 6% of all documented burials. These statistics do not include unmarked graves, and therefore pre-1900 burial percentages are likely to be higher. Statistically, the cemetery is dominated by modern burials; however, the

¹⁴ Ibid.

¹⁵ "Partial List of Early Interments" Pleasant Grove Baptist Cemetery (formerly Red Hill Cemetery).

¹⁶ Louise and Earl Hartgrove, "Pleasant Grove Baptist (former Red Hill Methodist Protestant) Cemetery" Guilford County Cemeteries, Volume 1: Western Section, Guilford County Genealogical Society, p. 73.

historic component of the cemetery remains significant for its association with the early development of a rural community in Guilford County.

Evaluation

Pleasant Grove Baptist Cemetery is **ELIGIBLE** for the National Register under Criterion A (event). Properties can be eligible for the National Register under Criterion A if they are associated with events that have made a significant contribution to the broad patterns of our history. Under Criterion A, the events or trends with which the burial place is associated must be clearly important, and the connection between the burial place and its associated context must be unmistakable. Pleasant Grove Baptist Cemetery represents an example of a rural community cemetery that began no later than the 1820s, and perhaps earlier. Local historians who have recorded cemeteries throughout Guilford County state that anyone from the community could bury a family member on this property.¹⁷ Many of the plots have no gravestones, and therefore the possibility remains that earlier graves may be present on the site. Ultimately, the cemetery represents the early foundations of a community in early 19th-century rural Guilford County, and therefore it satisfies Criteria Consideration A. Later, this property assumed the name of a church constructed in 1896, becoming the burial ground for congregants of Red Hill Methodist Church. At different periods of the 19th-century, the site has contained a church, school, and cemetery, extending the legacy of community into successive phases of history.

Pleasant Grove Baptist Cemetery is **NOT ELIGIBLE** for the National Register under Criterion B. Properties may be eligible for the National Register under Criterion B if they are associated with the lives of persons significant in our past. Under Criterion B, the person or group of persons with which the burial place is associated must be of *outstanding* importance to the community, state, or nation. Pleasant Grove Baptist Cemetery is not eligible under Criterion B, as there are no known persons or groups of outstanding significance associated with this site.

Pleasant Grove Baptist Cemetery is **NOT ELIGIBLE** for the National Register under Criterion C. Properties may be eligible for the National Register under Criterion C if they embody the distinctive characteristics of a type, period, or method of construction, or that represent the work of a master, or that possess high artistic values, or that represent a significant and distinguishable entity whose components may lack individual distinction. Pleasant Grove Baptist Cemetery is **NOT ELIGIBLE** for Criterion C because it does not meet any of these conditions.

Pleasant Grove Baptist Cemetery is **NOT ELIGIBLE** for the National Register under Criterion D. Properties may be eligible for the National Register under Criterion D if they have yielded, or may be likely to yield, information important in prehistory or history. Burial places may be eligible for their potential to yield information about cultural or ethnic groups. Under Criterion D, the common requirements are that the property have information to contribute and the

¹⁷ Louise and Earl Hartgrove, "Pleasant Grove Baptist Cemetery."

information is considered important. The importance of the information to be yielded usually is determined by considering a research design or a set of questions that could be resolved by controlled investigation of the site. While commonly understood to apply to archaeological research, Criterion D also encompasses information important in the study of material culture and social history. Pleasant Grove Baptist Cemetery is NOT ELIGIBLE under Criterion D because the site is not likely to yield important information important in prehistory or history.

Boundary

The National Register boundary for the Pleasant Grove Cemetery has been drawn according to the guidelines of National Register Bulletin 21, "Defining Boundaries for National Register Properties" and National Register Bulletin 41, "Guidelines for Evaluating and Registering Cemeteries and Burial Places." The boundary is drawn to include all known historic resources within the Pleasant Grove Cemetery. On the east side of the cemetery property, the boundary extends to the edge of pavement on SR 1129, Groometown Road. The National Register Boundary is delineated on a site plan (MAP-3).

National Register Boundary Justification

The entire cemetery has been included in the boundary because it has been documented that some historic burials are not marked by grave stones. As a result, the precise locations of many early graves is not known. On the east side of the cemetery, the boundary has been drawn to the edge of pavement on SR 1129 because some graves are located in close proximity to the roadway.

While the modern section of the cemetery has a greater proportion of burials, the size and scale of the new features do not overwhelm the historic component of the site. The overall impression of the cemetery is still of a small historic cemetery with a modern addition to the north and west. Further, the age and rarity of the early historic resources representing the early period of Guilford County's rural settlement, allow for a greater tolerance for any change, damage, or loss of historic features that may be apparent.



FIG. 1

PROPERTY # 3 - PLEASANT GROVE BAPTIST CHURCH (CEMETERY ELIGIBLE ONLY)



FIG. 2

PROPERTY # 3 - PLEASANT GROVE BAPTIST CEMETERY (ELIGIBLE)



PROPERTY # 3 - PLEASANT GROVE BAPTIST CEMETERY (ELIGIBLE)



PROPERTY # 3 - PLEASANT GROVE BAPTIST CEMETERY (ELIGIBLE)



PROPERTY # 3 - FORMER RED HILL BAPTIST CHURCH

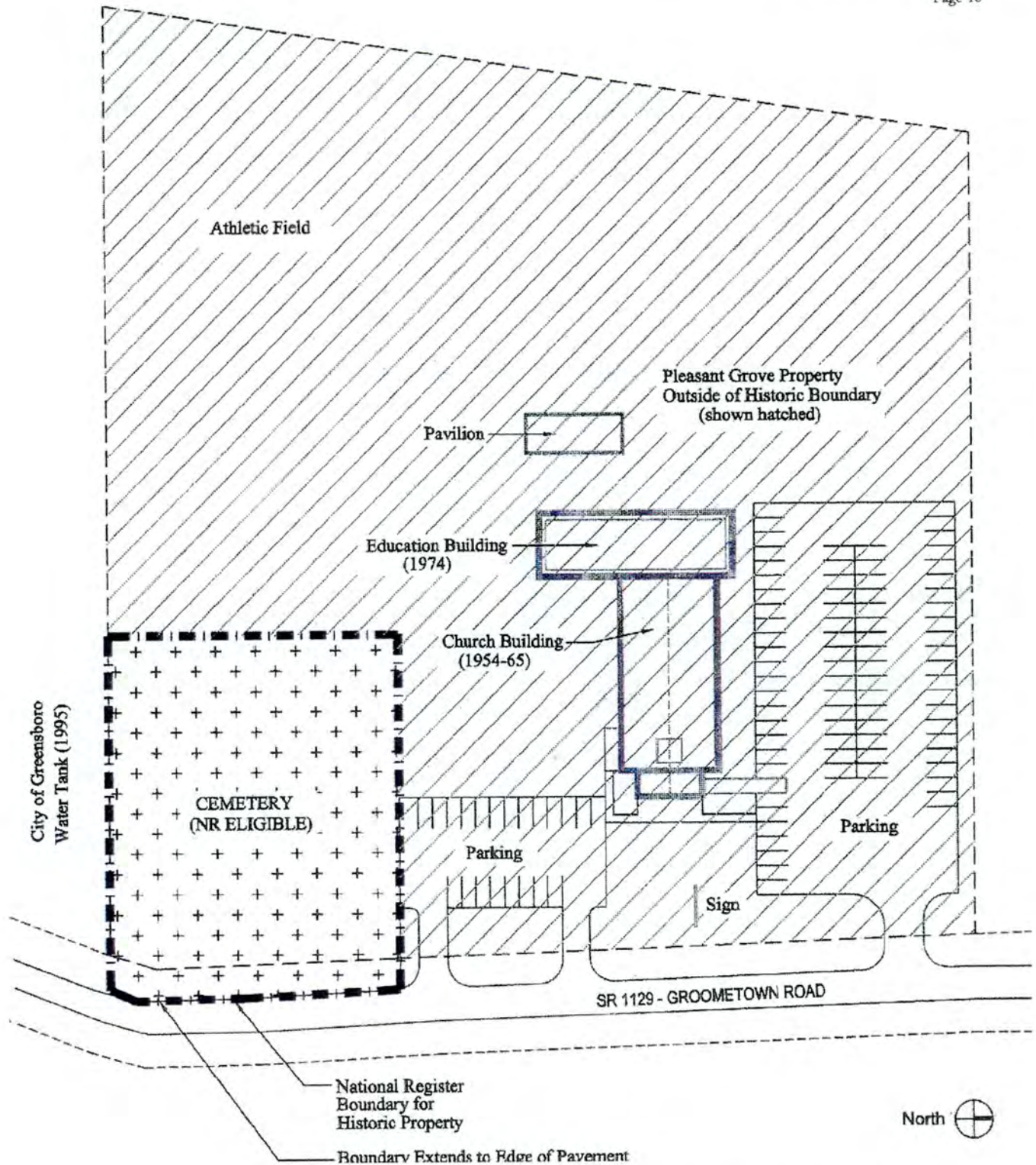

Historic Architecture
 NCDOT
 1 South Wilmington Street
 P.O. Box 25201
 Raleigh, NC 27611-5201
 T 919-733-7844
 F 919-733-9794
 www.dot.state.nc.us

Project
**SR 1129 - Groometown Road
 Greensboro, North Carolina**

Sheet Title
**HISTORIC BOUNDARY
 Pleasant Grove Baptist Cemetery**

Drawn By:
Silverman

Issue Date:
09-14-00

File Name:
map_3.ppt

TIP No.
U-3313

Scale

Sheet No.
MAP-3

C. PROPERTIES CONSIDERED NOT ELIGIBLE FOR THE NATIONAL REGISTER AND NOT WORTHY OF FURTHER EVALUATION

Property #4	House	2-story four square; lacks historic or architectural significance
Property #5	House	1-story eave-front cottage; lacks historic or architectural significance



PROPERTY #4



PROPERTY #5

VIII. BIBLIOGRAPHY

- Browning, Mary. **Guilford County Cemeteries, Volume I: Western Section.** Greensboro, NC: Guilford County Genealogical Society, 1996.
- Bradfield, Carl. Letters to Richard Silverman. 9 September 2000. NCDOT Historic Architecture files for U-3313.
- Letters to Pleasant Grove Baptist Church. 31 July 1989; 12 February 1999; 1 March 1999. Pleasant Grove Baptist Church files.
- Cockerham, Mildred, et. al. **Seventy Years of Growth at Pleasant Grove Baptist Church 1930-2000.** Greensboro, NC: Pleasant Grove Baptist Church, 2000.
- Guilford County Soil Map. United States Department of Agriculture, Bureau of Soils, 1920.
- "Historic Architectural Resources Survey Report, TIP# U-2424: Greensboro Western Urban Loop." Raleigh, NC: Historic Architecture Section, North Carolina Department of Transportation, 1991.
- Hughes, Fred. **Guilford County: A Map Supplement.** Jamestown: The Custom House, 1988.
- Map of Guilford County. Guilford County Board of County Commissioners, C.O. Lowe, Eng., Greensboro, NC, 1924-25.
- Map of Guilford County. O.W. Miller, C.E., Salisbury, NC, 1910.
- "National Register Bulletin 41: Guidelines for Evaluating and Registering Cemeteries and Burial Places." Washington, DC: U.S. Department of the Interior, National Park Service, Interagency Resources Division, National Register of Historic Places, 1992.
- "Partial List of Early Interments: Pleasant Grove Baptist Cemetery." Files of Pleasant Grove Baptist Church, Greensboro, NC.
- Robinson, Blackwell P., and Alexander R. Stoesen. **The History of Guilford County, North Carolina, U.S.A. to 1980, A.D.,** 1981.
- Weatherly, Andrew Earl. **The First Hundred Years of Historic Guilford, 1777-1871.** Greensboro: The Printworks, 1993.

APPENDIX A: NR BOUNDARY FOR SEDGEFIELD STABLES

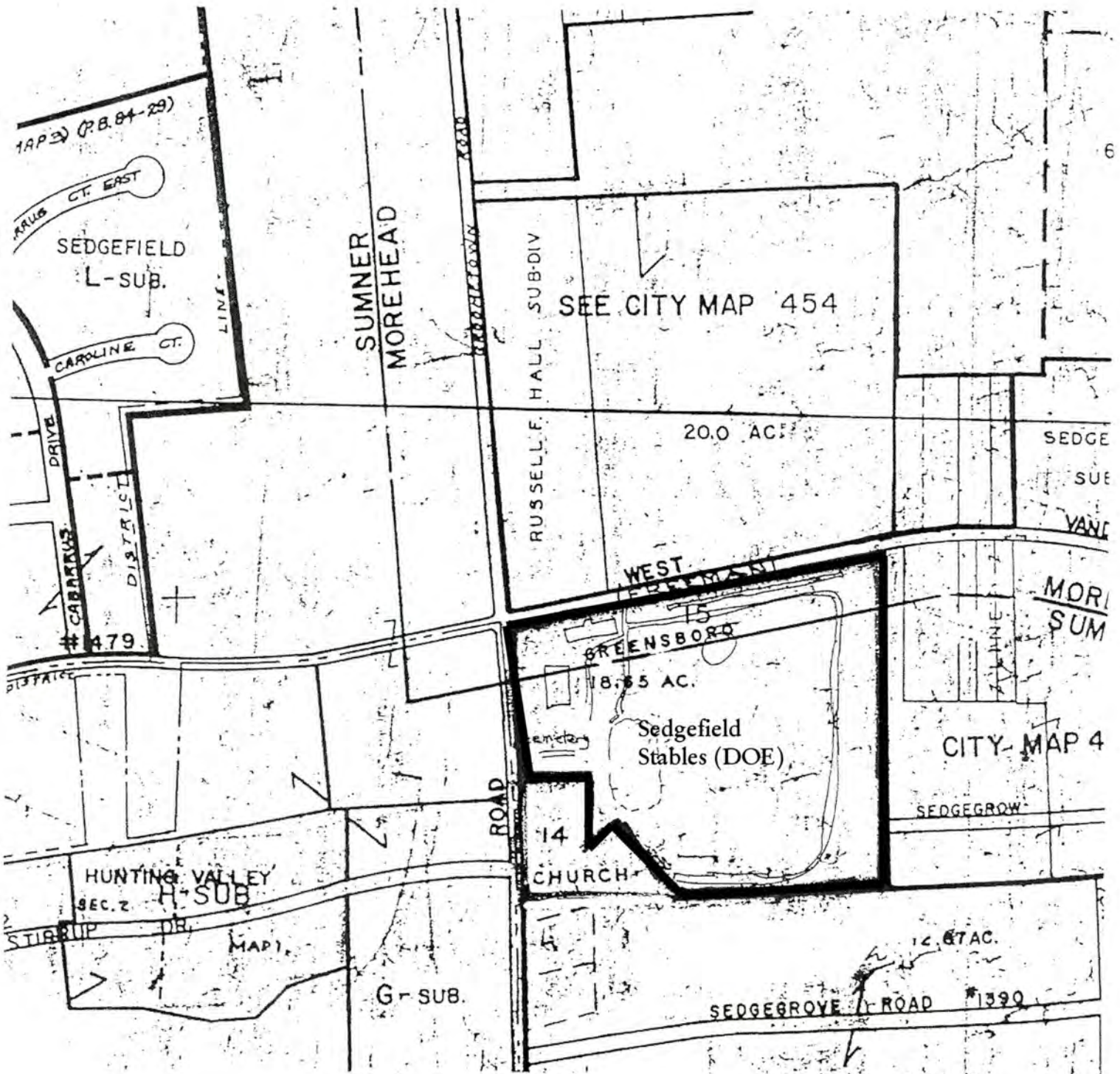

Note: The NR Boundary extends to the line of the right-of-way.

APPENDIX A: NR BOUNDARY FOR CELIA PHELPS METHODIST EPISCOPAL CHURCH

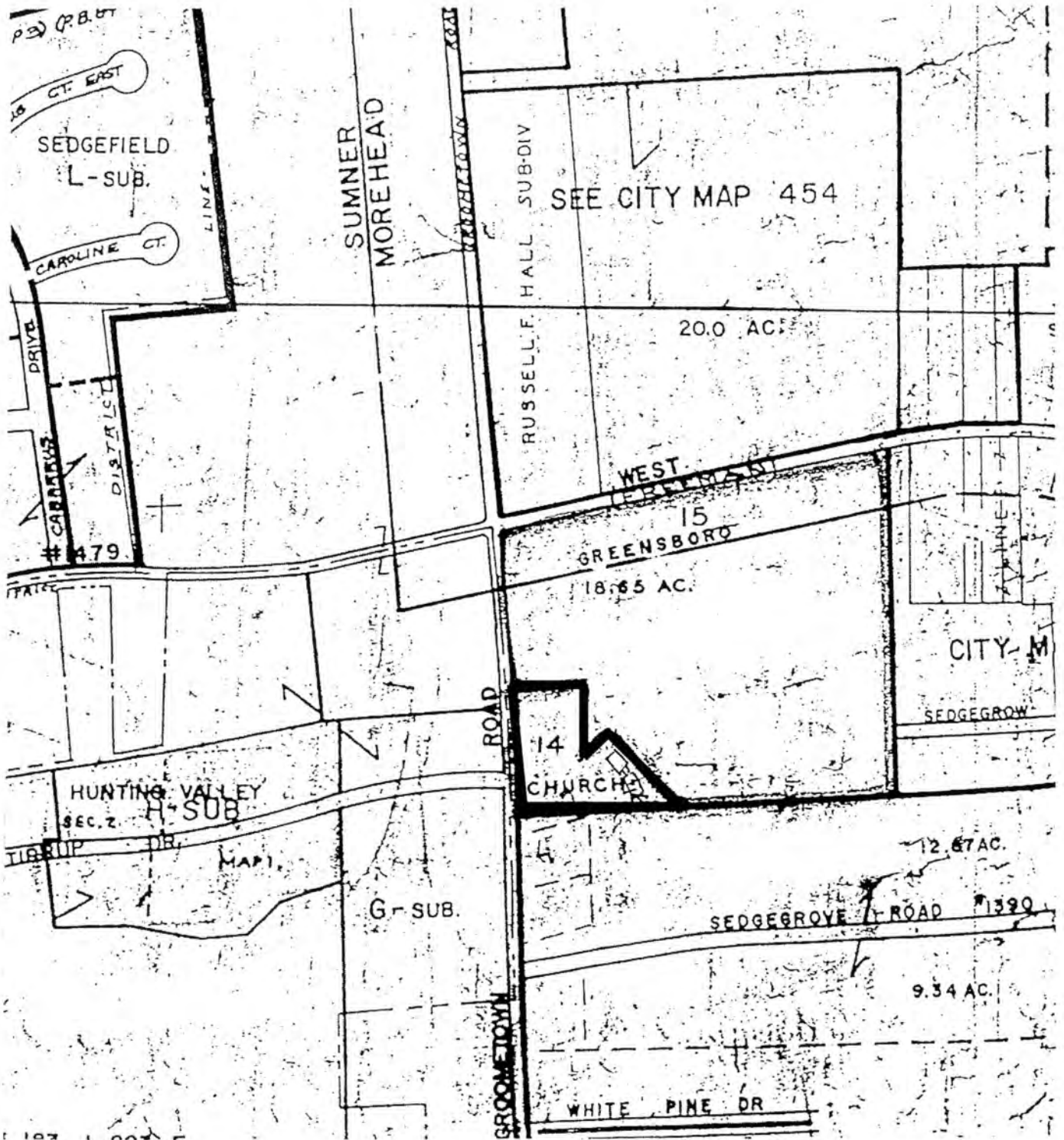

Note: The NR Boundary extends to the line of the right-of-way.

APPENDIX B:

CONCURRENCE FORM FOR PROPERTIES NOT ELIGIBLE FOR THE NATIONAL REGISTER

TIP # U-3313 Federal Aid # STP-1129(4) County GF

**CONCURRENCE FORM
FOR
PROPERTIES NOT ELIGIBLE FOR THE NATIONAL REGISTER OF HISTORIC PLACES**

Brief Project Description

WIDEN SR 1129 (GROOMETOWN ROAD)
GUILFORD CO, NC

On 09-07-00, representatives of the

- North Carolina Department of Transportation (NCDOT)
- Federal Highway Administration (FHWA)
- North Carolina State Historic Preservation Office (SHPO)
- Other _____

reviewed the subject project at:

- A scoping meeting
- Historic architectural resources photograph review session/consultation
- Other _____

All parties present agreed:

- there are no properties over fifty years old within the project's area of potential effect.
- there are no properties less than fifty years old which are considered to meet Criterion Consideration G within the project's area of potential effect.
- there are properties over fifty years old (list attached) within the project's area of potential effect, but based on the historical information available and the photographs of each property, properties identified as 4.5 are considered not eligible for the National Register and no further evaluation of them is necessary.
- there are no National Register-listed properties within the project's area of potential effect.
- there are no historic properties affected by this project

Signed:

Richard C. Schum 09-07-00
Representative, NCDOT Date

Michael D. Dawson 9/7/00
FHWA, for the Division Administrator, or other Federal Agency Date

April Montgomery 9/7/00
Representative, SHPO Date

-SIGNATURE PENDING-

State Historic Preservation Officer Date

If a survey report is prepared, a final copy of this form and the attached list will be included.