

INDIVIDUAL PROPERTY FORM FOR

MULTIPLE RESOURCE

THEMATIC NOMINATION

**1 NAME**

HISTORIC Abbott's Creek Primitive Baptist Church Cemetery

AND/OR COMMON

**2 LOCATION**

STREET & NUMBER East side SR 1743, 0.1 mi. NE of jct. with SR 1733

CITY, TOWN

Thomasville

NOT FOR PUBLICATION  
CONGRESSIONAL DISTRICT

STATE

North Carolina

VICINITY OF

CODE  
037

COUNTY  
Davidson

CODE  
057

**3 CLASSIFICATION**

CATEGORY	OWNERSHIP	STATUS	PRESENT USE	
<input type="checkbox"/> DISTRICT	<input type="checkbox"/> PUBLIC	<input checked="" type="checkbox"/> OCCUPIED	<input type="checkbox"/> AGRICULTURE	<input type="checkbox"/> MUSEUM
<input type="checkbox"/> BUILDING(S)	<input checked="" type="checkbox"/> PRIVATE	<input type="checkbox"/> UNOCCUPIED	<input type="checkbox"/> COMMERCIAL	<input type="checkbox"/> PARK
<input type="checkbox"/> STRUCTURE	<input type="checkbox"/> BOTH	<input type="checkbox"/> WORK IN PROGRESS	<input type="checkbox"/> EDUCATIONAL	<input type="checkbox"/> PRIVATE RESIDENCE
<input checked="" type="checkbox"/> SITE	<b>PUBLIC ACQUISITION</b>	<b>ACCESSIBLE</b>	<input type="checkbox"/> ENTERTAINMENT	<input type="checkbox"/> RELIGIOUS
<input type="checkbox"/> OBJECT	<input type="checkbox"/> IN PROCESS	<input type="checkbox"/> YES: RESTRICTED	<input type="checkbox"/> GOVERNMENT	<input type="checkbox"/> SCIENTIFIC
	<input type="checkbox"/> BEING CONSIDERED	<input checked="" type="checkbox"/> YES: UNRESTRICTED	<input type="checkbox"/> INDUSTRIAL	<input type="checkbox"/> TRANSPORTATION
	N/A	<input type="checkbox"/> NO	<input type="checkbox"/> MILITARY	<input checked="" type="checkbox"/> OTHER Cemetery

**4 OWNER OF PROPERTY**

NAME Abbott's Creek Missionary Baptist Church

STREET & NUMBER

RFD 2

CITY, TOWN

High Point

VICINITY OF

STATE

North Carolina

**5 LOCATION OF LEGAL DESCRIPTION**

COURTHOUSE, REGISTRY OF DEEDS, ETC Register of Deeds Office, Davidson County Courthouse

STREET & NUMBER

CITY, TOWN

Lexington

STATE  
North Carolina

**6 FORM PREPARED BY**

NAME / TITLE

/ Ruth Little, Consultant

ORGANIZATION

Survey and Planning Branch

DATE

July 26, 1983

STREET & NUMBER

Division of Archives and History

TELEPHONE

919/733-6545

CITY OR TOWN

Raleigh

STATE

North Carolina 27611

## 7 DESCRIPTION

CONDITION		CHECK ONE	CHECK ONE
<input type="checkbox"/> EXCELLENT	<input checked="" type="checkbox"/> DETERIORATED	<input checked="" type="checkbox"/> UNALTERED	<input checked="" type="checkbox"/> ORIGINAL SITE
<input checked="" type="checkbox"/> GOOD	<input type="checkbox"/> RUINS	<input type="checkbox"/> ALTERED	<input type="checkbox"/> MOVED      DATE _____
<input checked="" type="checkbox"/> FAIR	<input type="checkbox"/> UNEXPOSED		

---

### DESCRIBE THE PRESENT AND ORIGINAL (IF KNOWN) PHYSICAL APPEARANCE

The Abbott's Creek Primitive Baptist Church Cemetery contains approximately 450 gravestones, the earliest inscribed marker dated 1795. Approximately one dozen are uninscribed or illegible fieldstones which may be earlier. Three hundred fifty-one of these are of local manufacture, making this the largest collection of locally-made gravestones in Davidson County. The largest group of these, 67, belong to the "Pierced Style" attributed to the Swisegood School and its followers. The remainder represent a number of different carvers and are of lesser quality. The "Pierced" group have death dates from 1802 to the 1850s.

This graveyard has the only example of a Pierced style gravestone which is signed. The stone of Josiah Spurgin, died in 1802, is signed on the rear "MAID BY THE HAND OF JOSEPH CLODFELTER." Other unique characteristics of this graveyard are the presence of epitaphs, in English, on a number of the Pierced group, and the absence of gravestones inscribed in German. This is explained by the denomination of the church, which was composed of English and Scotch-Irish settlers, whereas German settlers belonged to Lutheran and German Reformed denominations. The following gravestones, grouped by schools, are most significant:

#### Early Phase

Anna Feagu(son?)	1778-1795	crude, monolithic stone
Rhoda Styers	1760-1824	incised floral ornament
Caty Styers	1784-1818	incised floral ornament
David Manring	1789-1819	incised floral ornament
Keziah Chipman	1799-1824	incised floral ornament
Eve Low	1746-1840	incised floral ornament
Samuel Styers	1760-1843	incised floral ornament
Julia B. Terry	no date	incised abstract ornament

#### Swisegood School

Josiah Spurgin	-1802	(signed by Joseph Clodfelter)
Joseph S. Williams	1822-1825	
Sarah Davis	1807-1829	
Samuel Ferguson	1789-1819	
Drusilla Swaim	1773-1822	
Eleanor O. Jones	1801-1824	
George Glascock	1806-1830	
Deliah Roberts	1786-1836	
Kezia Jones	1806-1828	

#### derivative Pierced Tradition

John Williams	1796-1811
Anna Jones	1789-1820
Christen A. Robertson	1823-1824
Solomon May	1825
Sarah Jones	1755-1824



PERIOD	AREAS OF SIGNIFICANCE -- CHECK AND JUSTIFY BELOW				
<input type="checkbox"/> PREHISTORIC	<input type="checkbox"/> ARCHEOLOGY-PREHISTORIC	<input type="checkbox"/> COMMUNITY PLANNING	<input type="checkbox"/> LANDSCAPE ARCHITECTURE	<input type="checkbox"/> RELIGION	
<input type="checkbox"/> 1400-1499	<input type="checkbox"/> ARCHEOLOGY-HISTORIC	<input type="checkbox"/> CONSERVATION	<input type="checkbox"/> LAW	<input type="checkbox"/> SCIENCE	
<input type="checkbox"/> 1500-1599	<input type="checkbox"/> AGRICULTURE	<input type="checkbox"/> ECONOMICS	<input type="checkbox"/> LITERATURE	<input checked="" type="checkbox"/> SCULPTURE	
<input type="checkbox"/> 1600-1699	<input type="checkbox"/> ARCHITECTURE	<input type="checkbox"/> EDUCATION	<input type="checkbox"/> MILITARY	<input type="checkbox"/> SOCIAL/HUMANITARIAN	
<input checked="" type="checkbox"/> 1700-1799	<input checked="" type="checkbox"/> ART	<input type="checkbox"/> ENGINEERING	<input type="checkbox"/> MUSIC	<input type="checkbox"/> THEATER	
<input type="checkbox"/> 1800-1899	<input type="checkbox"/> COMMERCE	<input type="checkbox"/> EXPLORATION/SETTLEMENT	<input type="checkbox"/> PHILOSOPHY	<input type="checkbox"/> TRANSPORTATION	
<input type="checkbox"/> 1900-	<input type="checkbox"/> COMMUNICATIONS	<input type="checkbox"/> INDUSTRY	<input type="checkbox"/> POLITICS/GOVERNMENT	<input type="checkbox"/> OTHER (SPECIFY)	
		<input type="checkbox"/> INVENTION			

SPECIFIC DATES Various

STONECUTTERS: Joseph Clodfelter and unknown others

#### HISTORICAL BACKGROUND

Abbott's Creek Primitive Baptist Church was organized about 1756 by the "Separatist" or "New Light" Baptist sect, an evangelical group which grew more rapidly than the older "Regular" Baptist sect because of their missionary fervor. Abbott's Creek and Jersey churches were the oldest Baptist congregations in this section of Piedmont North Carolina. Although many of the numerous gravestones of local craftsmanship in the cemetery were cut by local German stonecutters, the inscriptions are all in English, even on the earliest dated markers, and verse epitaphs are used frequently.

#### CRITERIA ASSESSMENT

A,C Derives primary significance from the unique collection of folk gravestones by local stonecutters erected here in the late eighteenth and first half of the nineteenth centuries. These highly decorative soapstone gravestones with folk symbols for resurrection and eternity represent the height of folk art accomplishment within the craft community of the Anglo-German farmers of north Davidson County.

Contains the largest and finest collection of "Pierced Style" gravestones in the county, representing the interesting adaptation of a German design idiom for a predominately Scotch-Irish congregation.

SITE PLAN

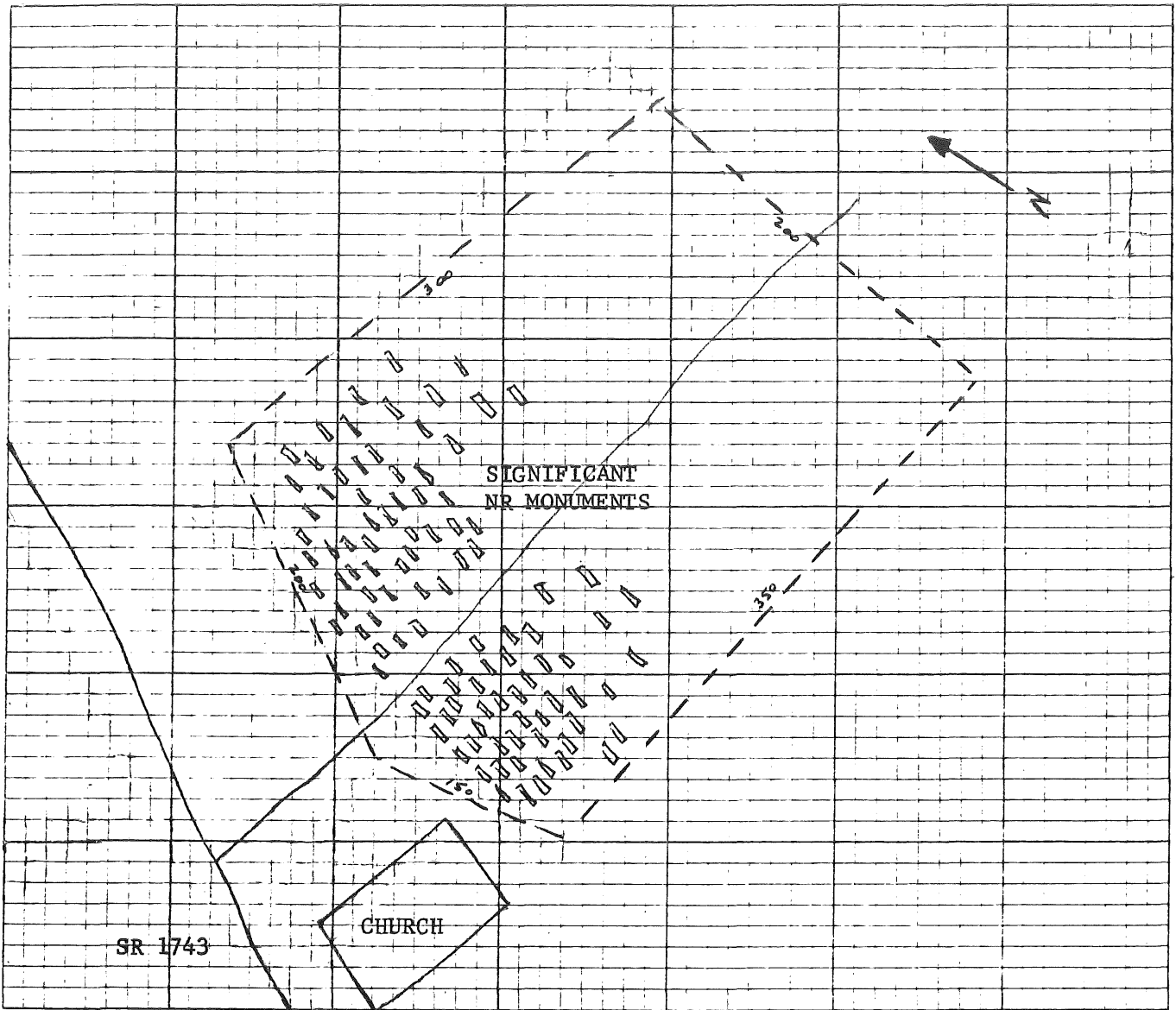

not to scale

**9 MAJOR BIBLIOGRAPHICAL REFERENCES**

N/A

**10 GEOGRAPHICAL DATA**

ACREAGE OF NOMINATED PROPERTY Approx. 2 acres

UTM REFERENCES

A | 1 7 | 5 8 2 6 0 0 | 3 9 8 4 7 4 0  
 ZONE EASTING NORTHING  
 C | | | | | | | | | | | | | | | | | |

B | | | | | | | | | | | | | | | | | |  
 ZONE EASTING NORTHING  
 D | | | | | | | | | | | | | | | | | |

VERBAL BOUNDARY DESCRIPTION

The cemetery boundaries include an area of roughly 2 acres with the approximate dimensions of 300 feet by 200 feet by 350 feet by 150 feet by 200 feet in a polygonal configuration as shown on the U.S. Geological Survey map, Kernersville, N.C., Quadrangle.

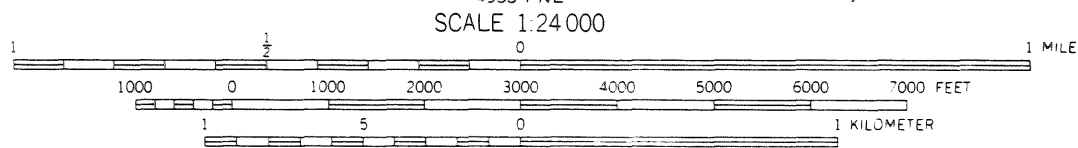
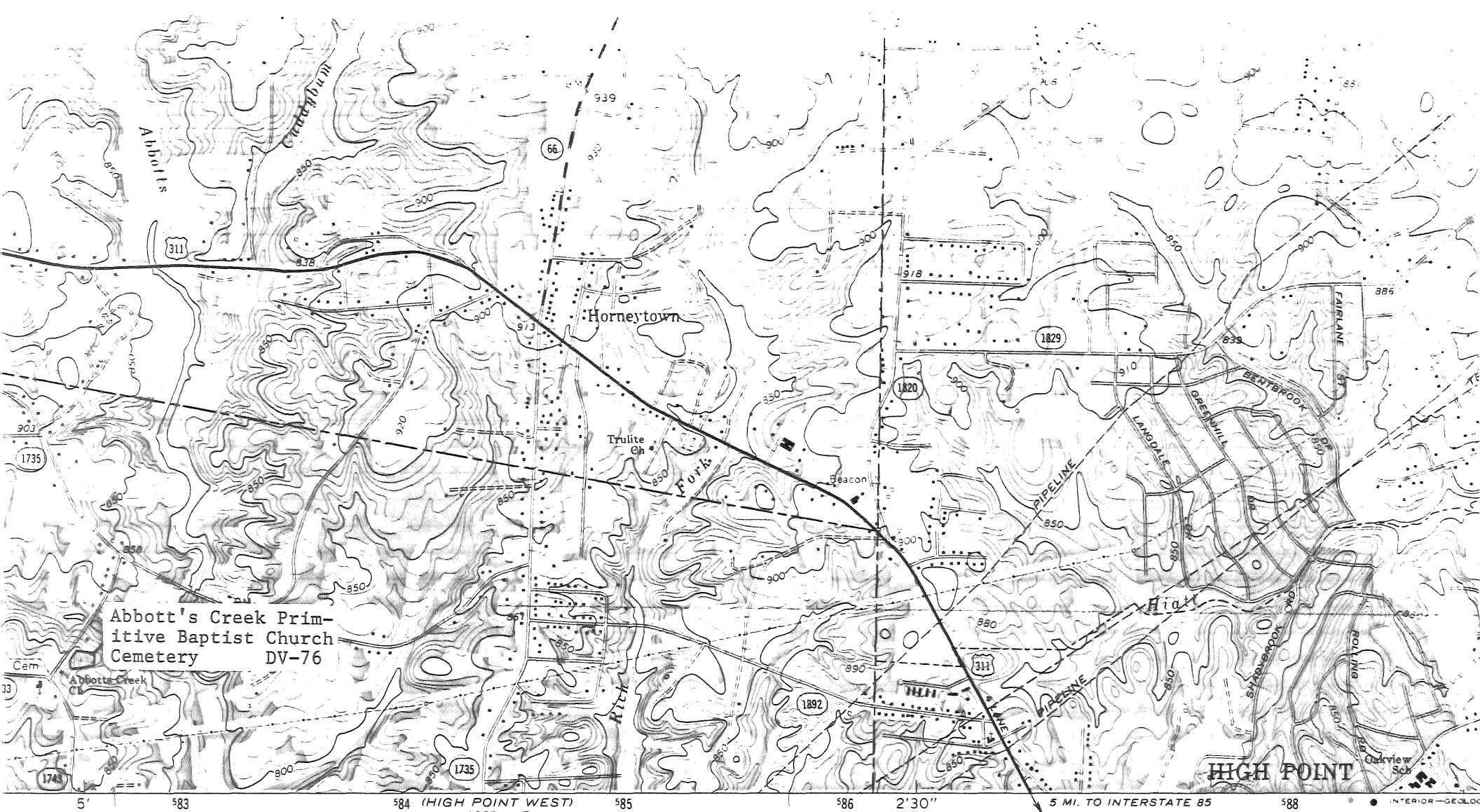

CONTOUR INTERVAL 10 FEET  
DATUM IS MEAN SEA LEVEL

- ROAD
- Primary highway hard surface
  - Secondary highway hard surface
  - Interstate Route



*Kernersville Quad*

THIS MAP COMPLIES WITH NATIONAL MAP ACCURACY STANDARDS  
FOR SALE BY U.S. GEOLOGICAL SURVEY WASHINGTON D.C. 20242  
A FOLDER DESCRIBING TOPOGRAPHIC MAPS AND SYMBOLS IS AVAILABLE ON REQUEST

C NORTH SHEET









Elisabeth

Bodenham

Daughter of P & A

Born 2 Nov 18

Died 10 Jan 18