

United States Department of the Interior
National Park Service

National Register of Historic Places Registration Form

This form is for use in nominating or requesting determinations of eligibility for individual properties or districts. See instructions in *Guidelines for Completing National Register Forms* (National Register Bulletin 16). Complete each item by marking "x" in the appropriate box or by entering the requested information. If an item does not apply to the property being documented, enter "N/A" for "not applicable." For functions, styles, materials, and areas of significance, enter only the categories and subcategories listed in the instructions. For additional space use continuation sheets (Form 10-900a). Type all entries.

1. Name of Property

historic name Reinhardt, William Pinckney House
other names/site number Reinhardt, Pink House; Reinhardt-Sigmon House; Sigmon House

2. Location

street & number W cor., jct. of SR 2012 & SR 2013 not for publication
city, town Maiden vicinity
state North Carolina code NC county Catawba code 035 zip code 28658

3. Classification

Ownership of Property	Category of Property	Number of Resources within Property	
<input checked="" type="checkbox"/> private	<input checked="" type="checkbox"/> building(s)	Contributing	Noncontributing
<input type="checkbox"/> public-local	<input type="checkbox"/> district	<u>1</u>	<u>0</u> buildings
<input type="checkbox"/> public-State	<input type="checkbox"/> site	<u>0</u>	<u>0</u> sites
<input type="checkbox"/> public-Federal	<input type="checkbox"/> structure	<u>0</u>	<u>0</u> structures
	<input type="checkbox"/> object	<u>1</u>	<u>0</u> objects
		<u>1</u>	<u>0</u> Total

Name of related multiple property listing: Historic & Architectural Resources of Catawba County, N.C.
Number of contributing resources previously listed in the National Register 0

4. State/Federal Agency Certification

As the designated authority under the National Historic Preservation Act of 1966, as amended, I hereby certify that this nomination request for determination of eligibility meets the documentation standards for registering properties in the National Register of Historic Places and meets the procedural and professional requirements set forth in 36 CFR Part 60. In my opinion, the property meets does not meet the National Register criteria. See continuation sheet.

William S. Pinckney June 4, 1990
Signature of certifying official Date

State or Federal agency and bureau _____

In my opinion, the property meets does not meet the National Register criteria. See continuation sheet.

Signature of commenting or other official Date

State or Federal agency and bureau _____

5. National Park Service Certification

I, hereby, certify that this property is:

entered in the National Register. See continuation sheet. _____

determined eligible for the National Register. See continuation sheet. _____

determined not eligible for the National Register. _____

removed from the National Register. _____

other, (explain:) _____

Signature of the Keeper

Date of Action

6. Function or Use

Historic Functions (enter categories from instructions)

Domestic: single dwelling

Current Functions (enter categories from instructions)

Domestic: single dwelling

7. Description

Architectural Classification
(enter categories from instructions)

Greek Revival

Materials (enter categories from instructions)

foundation stone
walls weatherboard

roof asphalt
other wood
stucco

Describe present and historic physical appearance.

The **William Pinckney Reinhardt House** is a refined, two-story frame dwelling in the Greek Revival style, probably built ca. 1845 and nearly identical to the neighboring Franklin D. Reinhardt House (also included in the "Historic & Architectural Resources of Catawba County, N.C."). The one-and-one-half story addition on the rear of the house was constructed during the 1920s by George Monroe Sigmon.

The William Pinkney Reinhardt House is located northwest of the town of Maiden in rural south central Catawba County. The house faces southeast on a hill with a commanding view of the surrounding open countryside between Clark Creek and Betts Branch. The house yard is bordered on the southeast by Cedar Grove Road (SR 2012), on the northeast by Sigmon Dairy Road (SR 2013), and on the northwest and southwest by a driveway which connects these two roads. Several large trees, predominantly oak, are scattered throughout the yard, and the house itself is surrounded by boxwoods and other shrubbery. Beyond the immediate yard are the multiple twentieth century dairy buildings and the fields and pasture lands associated with the Sigmon Dairy. These service buildings date largely from the last fifteen years, and do not contribute to the historic significance of the Reinhardt House, and are therefore excluded from this nomination.

The original two-story portion of the three-bay-wide Reinhardt House is sheathed in weatherboard siding that was covered with vinyl in 1983. The stuccoed stone foundation has cellar ventilators located beneath first story windows. Originally these ventilators had vertical wood slats, but in the 1940s those that were exposed were replaced with two-light glass windows. The entrance to the cellar is located on the southwest side to the rear of the chimney. First story windows of the house are nine-over-nine sash, while those on the second story are nine-over-six sash, except for the center bay window above the porch, which is only six-over-six sash. At the gable roof, ogee-molded rake boards on the northeast and southwest sides and a boxed cornice on front (southeast) and rear (northwest), with the same ogee molding and a more delicate molded band on the

United States Department of the Interior
National Park ServiceNational Register of Historic Places
Continuation SheetSection number 7 Page 1William Pinckney Reinhardt House
Catawba County, N.C.

frieze beneath the eaves, remain intact but are now concealed by the vinyl siding, as are the flat window surrounds. Wood shingles remain visible under the present asphalt-shingled roofing. Centered on each end of the house is a single-stepped-shoulder chimney in common bond brickwork with free-standing stack and with slightly projecting brick and stuccoed stone base. At the attic they are flanked by four-light windows.

The focal point of the facade (southeast side) is the Greek Revival style center bay portico with sophisticated Asher Benjamin-inspired doorway. The small porch is supported by two stuccoed-brick Doric columns set on high plinths located beyond the outer corners of the porch floor (so that the columns rest on the ground rather than the floor). Originally there were two additional columns set between the corner columns, but these collapsed ca. 1950. The remaining Doric columns with their cushion caps support a plain entablature and hipped roof. After the columns collapsed, the original wood floor with wooden balustrade was replaced by the present cement floor with its modern ironwork balustrade. The eight-panel door is surrounded by a narrow, symmetrically-molded casing with plain corner blocks, which in turn is surrounded by sidelights and transom with grid-patterned muntins and a wide, symmetrically-molded outer casing with plain and diamond-patterned corner blocks. Above and below the sidelights are wood panels. The design of the entrance is derived from an Asher Benjamin design and survives thoroughly intact.

A 1920s one-and-one-half story addition spans the rear of the Reinhardt House. It is characterized by a broad gable roof, interior brick chimney, a band of six-over-six sash windows on the southwest side, two four-over-four sash windows on the northeast side, and two six-over-six sash windows in the gable peak. The enclosed rear porch has a hipped roof, a band of six-over-six sash windows, and cement steps with ironwork balustrade leading to the rear entrance. The 1920s addition replaced a two-story ell at the west corner of the house. (The construction date of this ell is not known, but physical evidence suggests that it was not original.)

United States Department of the Interior
National Park ServiceNational Register of Historic Places
Continuation SheetSection number 7 Page 2William Pinckney Reinhardt House
Catawba County, N.C.

The two-story section of the Reinhardt House has a center hall plan with two rooms per floor. Detailing is largely consistent throughout this part of the house. Outer walls are plastered, while the walls dividing the rooms from the center hall are vertical flush-boarded partitions. Ceilings are flush sheathed. Baseboards surrounding the rooms on both floors have Greek molding. First story doors are six-panelled, while those on the second story are four-paneled. All doors have a flat surround with heavily beaded inner edge and plain corner blocks. Windows are treated in the same manner, but with the addition of a paneled apron beneath each window. All four fireplaces in the house have simple Greek Revival mantels with plain corner and base blocks and a pedimented backboard. Those on the first story are larger than those on the second. The stair to the second story rises from the rear of the center hall along the southwest wall. The detailing of the stair -- with its unusually tall tapered newel with molded cap, delicate Owen Biddle-inspired stair brackets (plate 31, Owen Biddle's Young Carpenter's Assistant, 1810), square balusters, and rounded handrail which is dramatically ramped at second story level -- is identical to that of the Franklin D. Reinhardt House. Beneath the stair on the first story was a small closet, enclosed by a four-panel door. The door remains, but the closet has been converted to an interior stair to the cellar. At the rear (northwest end) of the second story hall, a six-panel door opens to an enclosed stair (over the main stair) to the attic. At the front of the upstairs hall (in the east corner) is an original built-in cupboard, or linen press, with double-leaf paneled doors. This same feature is found at the Franklin D. Reinhardt House, as is the two-panel apron beneath the six-over-six sash window at the front end of the hall.

The attic of the William Pinckney Reinhardt House has sawn framing and two four-light windows at each end. The full cellar has had a cinderblock projecting "shelf" added to all four sides of the stone-walled area, and the floor is now covered with cement. The southwest end has one large original fireplace. Heavy timber joists and sills are still visible. While the outside entrance to the cellar remains on the southwest side, a stair has been added in the center, which leads to the first story hall by way of the (former) closet door under the main stair.

The rear addition of the Reinhardt House is entered via

United States Department of the Interior
National Park Service

National Register of Historic Places Continuation Sheet

Section number 7 Page 3

William Pinckney Reinhardt House
Catawba County, N.C.

doors from the dining room (southwest room), center hall, and living room (northeast room) on the first story. The dining room opens to the kitchen, which extends to the enclosed rear porch. The living room opens to a bedroom in the rear addition, and between this bedroom and the kitchen is a small sitting room. A glass-paned French door separates this room from the center hall. Behind this sitting room is an enclosed back porch, and in the northeast corner of the former rear porch is a bathroom, added in the 1930s. On the second story a door (which originally was a window) at the rear of the hall leads to the single half-story upper room of the rear addition, used as a bedroom. The rooms of the rear addition are not architecturally distinctive.

8. Statement of Significance

Certifying official has considered the significance of this property in relation to other properties:

nationally statewide locally

Applicable National Register Criteria A B C D

Criteria Considerations (Exceptions) A B C D E F G

Areas of Significance (enter categories from instructions)
Architecture

Period of Significance
ca. 1845

Significant Dates
ca. 1845

Cultural Affiliation
N/A

Significant Person
N/A

Architect/Builder
Unknown

State significance of property, and justify criteria, criteria considerations, and areas and periods of significance noted above.

Summary

The William Pinckney Reinhardt House, an imposing two-story frame Greek Revival style farmhouse built in the mid-1840s for this prosperous farmer and civic leader, is one of at least three stylish plantation houses in Catawba County that reflect patronage of carpenters familiar with the architectural pattern books of Asher Benjamin and Owen Biddle. As an exceptional farmhouse for Catawba County, the William Pinckney Reinhardt House fits into a regional piedmont North Carolian context of Greek Revival style plantation houses built by local carpenters employing national design pattern books for architectural details. Despite the application of vinyl siding, the house meets the registration requirements of the Property Type "Houses of Catawba County: Antebellum (1800-1864)," under Criterion C, due to retention of overall form, chimneys, unusual masonry porch columns, and the finely crafted and stylish Asher-Benjamin-inspired entrance surround. The interior is noteworthy for its high degree of integrity and, in particular, the staircase with Owen Biddle-inspired brackets. Although it was the seat of a large farm, the remaining farm acreage is now functioning as a modern dairy and does not contribute to the historical significance of the house.

United States Department of the Interior
National Park Service

National Register of Historic Places Continuation Sheet

Section number 8 Page 1

William Pinckney Reinhardt House
Catawba County, N.C.

Historical Background

The Reinhardt family was one of many Catawba County families of German ancestry. Daniel Reinhardt was born in Germany around 1716. He went to Philadelphia in 1739 and settled in York County, Pennsylvania as a tanner. The eldest of his children was Christian Reinhardt, born in Germany in 1735. Christian moved to Lincoln County and settled near Ramsour's Mill. He married Barbara Elizabeth Warlick (1754-1806) and they had three children. The second of the three was John Reinhardt (1773-1845), who lived in what would become Catawba County and who represented Lincoln County in the House of Commons in 1799 and 1800. He and his wife, the former Annie Moore, had a number of children, one of whom was William Pinckney Reinhardt.¹

Shortly before John Reinhardt's death in 1845 he deeded a 377 acre tract to William P. Reinhardt in exchange for the "natural love" that he held for his son. The deed mentions that the younger Reinhardt was already living on the property obtained from his father, suggesting that the Greek Revival house may have been constructed prior to 1845.²

William P. Reinhardt was a prosperous and successful farmer. The 1850 census shows that he owned 480 acres, with 200 under cultivation. His real estate was valued at \$3,360 and his livestock at \$912. His livestock holdings were extensive and included 6 horses, 5 mules, 5 cows, 50 sheep, and 45 swine. Reinhardt grew crops typical of antebellum Catawba County, such as corn (1,100 bushels), wheat, rye, and hay. He owned 17 slaves in 1850 and 25 in 1860.³

Reinhardt was elected to the General Assembly of North Carolina during the early days of the Civil War and served in that body from 1862 until 1867. After the war Reinhardt and his wife, the former Mary Forney, moved to Hickory and opened a boarding house. He was also active in a number of Hickory civic affairs. The Reinhardts had no children. In 1876 he sold his house and 388 acres to Henry F. Carpenter for \$5,500.⁴

Carpenter was a prominent local farmer who owned land in the Newton township prior to purchasing the Reinhardt property. In 1880 Carpenter owned over 800 acres, valued at \$8,000. It is likely that his son Leonidas A. Carpenter, lived at the Reinhardt House prior to his acquisition of the property from his father in the 1880s. The 1880 census shows L. A. Carpenter, his wife and

United States Department of the Interior
National Park Service

National Register of Historic Places Continuation Sheet

Section number 8 Page 2

William Pinckney Reinhardt House
Catawba County, N.C.

two children at a different household, from Henry Carpenter. The Carpenters owned the Reinhardt property until 1905 when L. A. Carpenter sold the house and 119 1/2 acres to Albert Sigmon for \$3,325.⁵

Albert Sigmon continued to farm the land until the late 1920s when the house became the property of his son George Monroe Sigmon, who built a one-and-one-half-story extension. George Sigmon expanded his holdings and also continued to farm the land. Tax records show him with ownership of the land worth \$6,000 in 1935, \$12,023 in 1945, \$16,958 in 1955 and \$23,016 in 1965.⁶ The house is now owned by Michael M. Sigmon (son of George Sigmon) and his wife, and their son Kenny lives in the house and works the farm.

FOOTNOTES

¹Charles L. Sigmon, "History of the Jacob Reinhardt Family" (Unpublished, no pagination), copy in file; Hickory Democrat, September 3, 1914.

²Catawba County Deed Book 3, p. 566.

³Seventh Census of the United States, 1850, Catawba County, North Carolina, Agricultural Schedule, Population Schedule, Slave Schedule; Eighth Census of the United States, 1860, Catawba County, North Carolina, Slave Schedule.

⁴Hickory Democrat, September 3, 1914; John L. Cheney, Jr., North Carolina Government, 1585-1974: A Narrative and Statistical History (Raleigh: North Carolina Department of the Secretary of State, 1975), 329, 331, 334; Catawba County Deed Book 10, p. 357; Charles J. Preslar, Jr., A History of Catawba County (Salisbury: The Rowan Printing Company, 1954), 63, 132, 345.

United States Department of the Interior
National Park Service

National Register of Historic Places Continuation Sheet

Section number 8, 9 Page 3, 1

William Pinckney Reinhardt House
Catawba County, N.C.

Footnotes, continued...

⁵Tenth Census of the United States, 1880, Catawba County, North Carolina, Agricultural Schedule, Population Schedule; Catawba County Deed Book 13, p. 130, Book 20, p. 34, Book 76, p. 400; Twelfth Census of the United States, 1900, Catawba County, North Carolina, Population Schedule.

⁶Catawba County Deed Book 891, p. 230; Catawba County Tax Scrolls 1915, 1925, 1935, 1945, and 1955.

BIBLIOGRAPHY

Catawba County Records: Deed Books, Tax Scrolls. Microfilm copies. Raleigh: Division of Archives and History.

Cheney, John L., Jr. North Carolina Government, 1585-1974: A Narrative and Statistical History. Raleigh: North Carolina Department of the Secretary of State, 1975.

Hickory Democrat. September 13, 1914.

Preslar, Charles J., Jr. A History of Catawba County. Salisbury: The Rowan Printing Company, 1954.

Sigmon, Charles L. "History of the Jacob Reinhardt Family." Unpublished. Copy in file.

United States Census Office. Seventh Census of the United States, 1850, Catawba County, North Carolina, Agricultural Schedule, Population Schedule, Slave Schedule; Eighth Census of the United States, 1860, Catawba County, North Carolina, Slave Schedule; Tenth Census of the United States, 1880, Catawba County, North Carolina, Agricultural Schedule, Population Schedule; Twelfth Census of the United States, 1900, Catawba County, North Carolina, Population Schedule. Microfilm copies. Raleigh: Division of Archives and History.

9. Major Bibliographical References

See continuation sheet

Previous documentation on file (NPS):

- preliminary determination of individual listing (36 CFR 67) has been requested
- previously listed in the National Register
- previously determined eligible by the National Register
- designated a National Historic Landmark
- recorded by Historic American Buildings Survey # _____
- recorded by Historic American Engineering Record # _____

Primary location of additional data:

- State historic preservation office
- Other State agency
- Federal agency
- Local government
- University
- Other

Specify repository: _____

10. Geographical Data

Acreage of property less than one (1) acre

UTM References

A

1	7
---	---

4	7	8	5	0	0
---	---	---	---	---	---

3	9	4	0	0	3	0
---	---	---	---	---	---	---

Zone Easting Northing

B

--	--

--	--	--	--	--	--

--	--	--	--	--	--	--

Zone Easting Northing

C

--	--

--	--	--	--	--	--

--	--	--	--	--	--	--

D

--	--

--	--	--	--	--	--

--	--	--	--	--	--	--

See continuation sheet

Verbal Boundary Description

Starting at the northeast corner of lot 12B in block 1, Catawba County tax map 46N, where SR 2012 and SR 2013 intersect, follow the northwest side of SR 2012 southwest 140 feet to a driveway; then follow the driveway northwest 275 feet; turn northeast and follow the driveway 240 feet; turn southeast and follow the southwest side of SR 2013 275 feet to the point of beginning.

See continuation sheet

Boundary Justification

The nominated property includes the house and immediate yard which is sufficient to convey the historic setting. The remainder of the sizeable farm is excluded due to its conversion to a dairy operation with numerous post-World War II buildings.

See continuation sheet

11. Form Prepared By

name/title Barbara Kooiman, compiler; Laura A.W. Phillips, description; Jim Sumner, history
organization Catawba County Historical Assoc. date June 1989
street & number Rt. 1, Box 76 AB telephone 704/256-3040
city or town Conover state N.C. zip code 28658

United States Department of the Interior
National Park Service

National Register of Historic Places Continuation Sheet

Section number Photos Page 1 William Pinckney Reinhardt House
Catawba County, NC

The following information applies to all photographs unless otherwise noted:

- 1) William Pinckney Reinhardt House
 - 2) Maiden vicinity, North Carolina
 - 3) Davyd Foard Hood
 - 4) March 1990
 - 5) North Carolina Division of Archives and History, Raleigh, NC
-
- A. 6) Overall view including main facade, to north
 - B. 6) Main entrance, to northwest
 - C. 6) Overall view showing rear, to south
 - D. 3) F. Bogue Wallin
 - 4) 1980
 - 6) First floor interior, panelled window apron

NOTE: The interior photos was taken in 1980. Examination of the house in 1989 by Barbara Kooiman confirmed that the interior remains unchanged from the appearance and condition recorded in the initial, 1980 survey photos.

UNITED STATES
DEPARTMENT OF THE INTERIOR
GEOLOGICAL SURVEY

4755 HILL NE
(HICKORY)

HICKORY 13 MI.
NEWTON 2.8 MI.

ZONE 17 81° 15' 35° 37' 30"

MAIDEN QUAD

- A E-478360 N-3942100
- B E-477920 N-3941500

REINHARDT
&
HARREN-HOOD
FARMS

- C E-478140 N-3940960
- D E-478040 N-3940980

MAIDEN QUAD
ZONE 17

- Wm. PINKNEY REINHARDT HOUSE
- E-477500
 - N-3940000

MAIDEN QUAD
ZONE 17

- MEMORIAL FEEDING LURCH
- E-480960
 - N-3936620

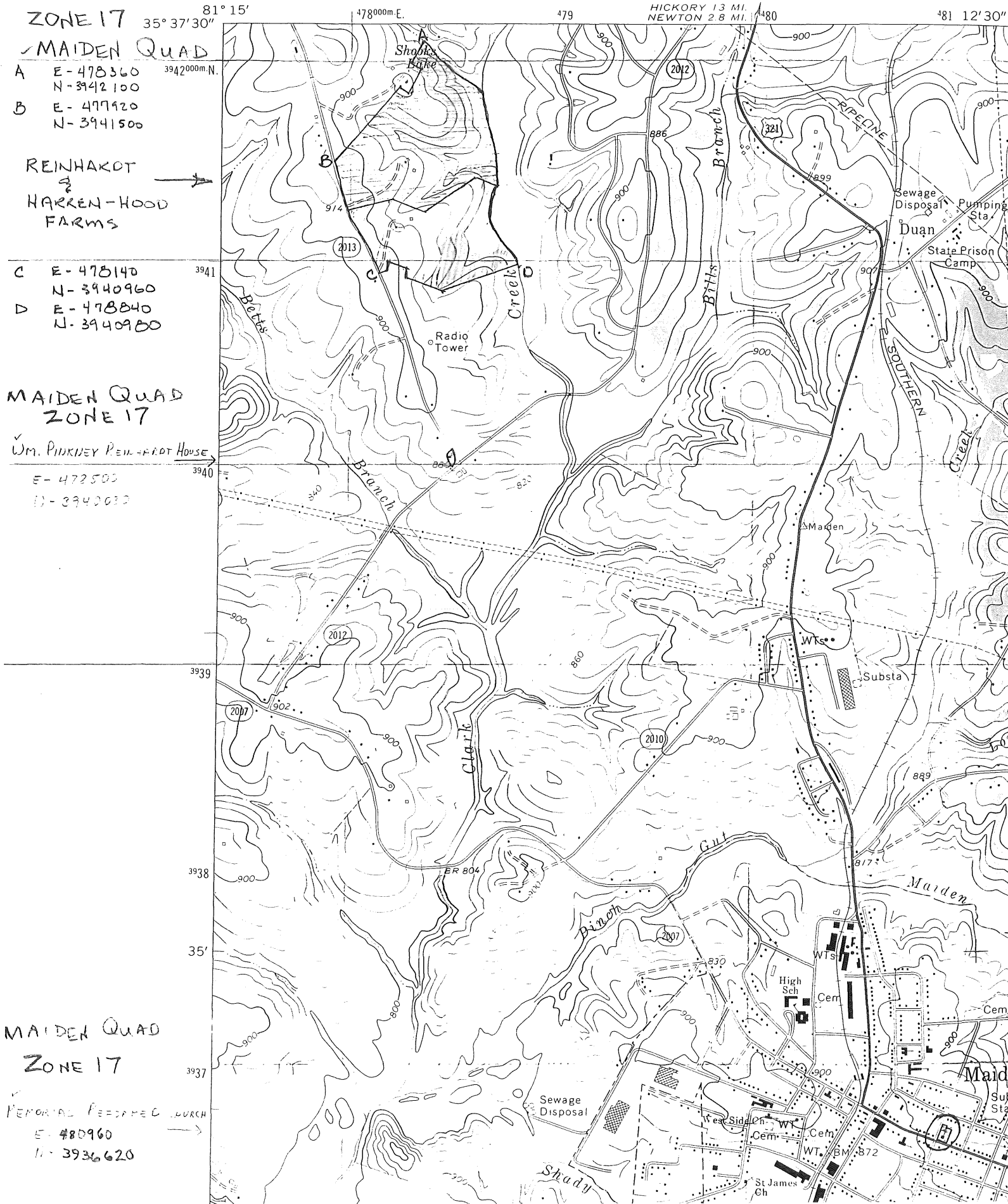

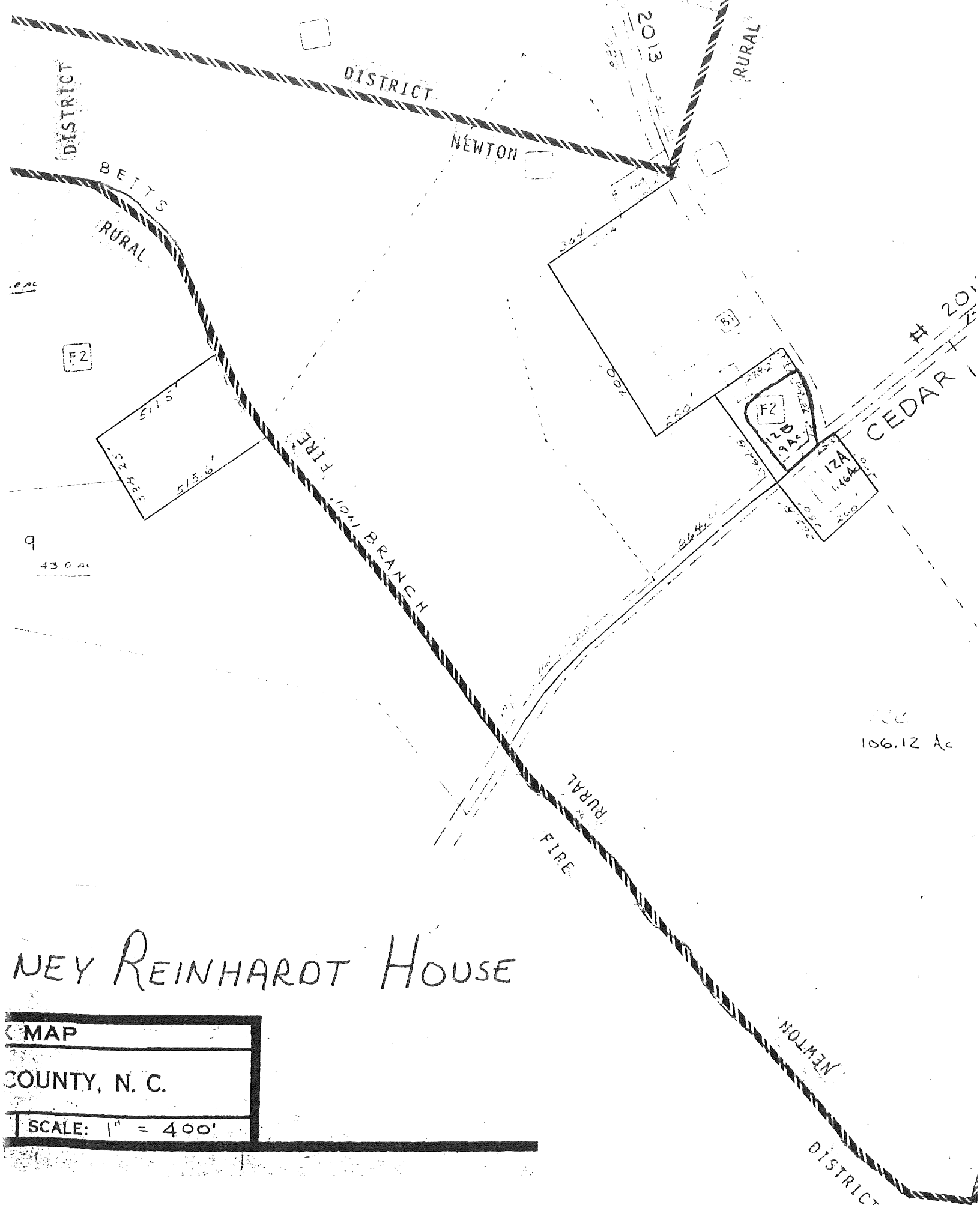

NEY REINHARDT HOUSE

MAP
 COUNTY, N. C.
 SCALE: 1" = 400'

